

ESTIMATION OF MATERIAL PLACED WITHIN THE WOUS BOUNDARY						
	OVERALL		PLACED BELOW EXISTING GROUND ELEVATION		PLACED ABOVE EXISTING GROUND ELEVATION	
SOIL (INCLUDES BACKFILL OF THE STRUCTURE EXCAVATION)	11755	CY	2100	CY	9655	CY
RIPRAP	438	CY	394	CY	44	CY
CRUSHED AGGREGATE BEDDING MATERIAL	557	CY	473	CY	84	CY
CONCRETE (WINGWALLS & CBC)	681	CY	545	CY	136	CY
GROUTED BOULDERS	677	CY	508	CY	169	CY
TOTAL	14108	CY	4020	CY	10088	CY

ESTIMATION OF MATERIAL REMOVED WITHIN THE WOUS BOUNDARY		
SOIL (INCLUDES STRUCTURE EXCAVATION)	3812	CY
RIPRAP	749	CY
TOTAL	4561	CY

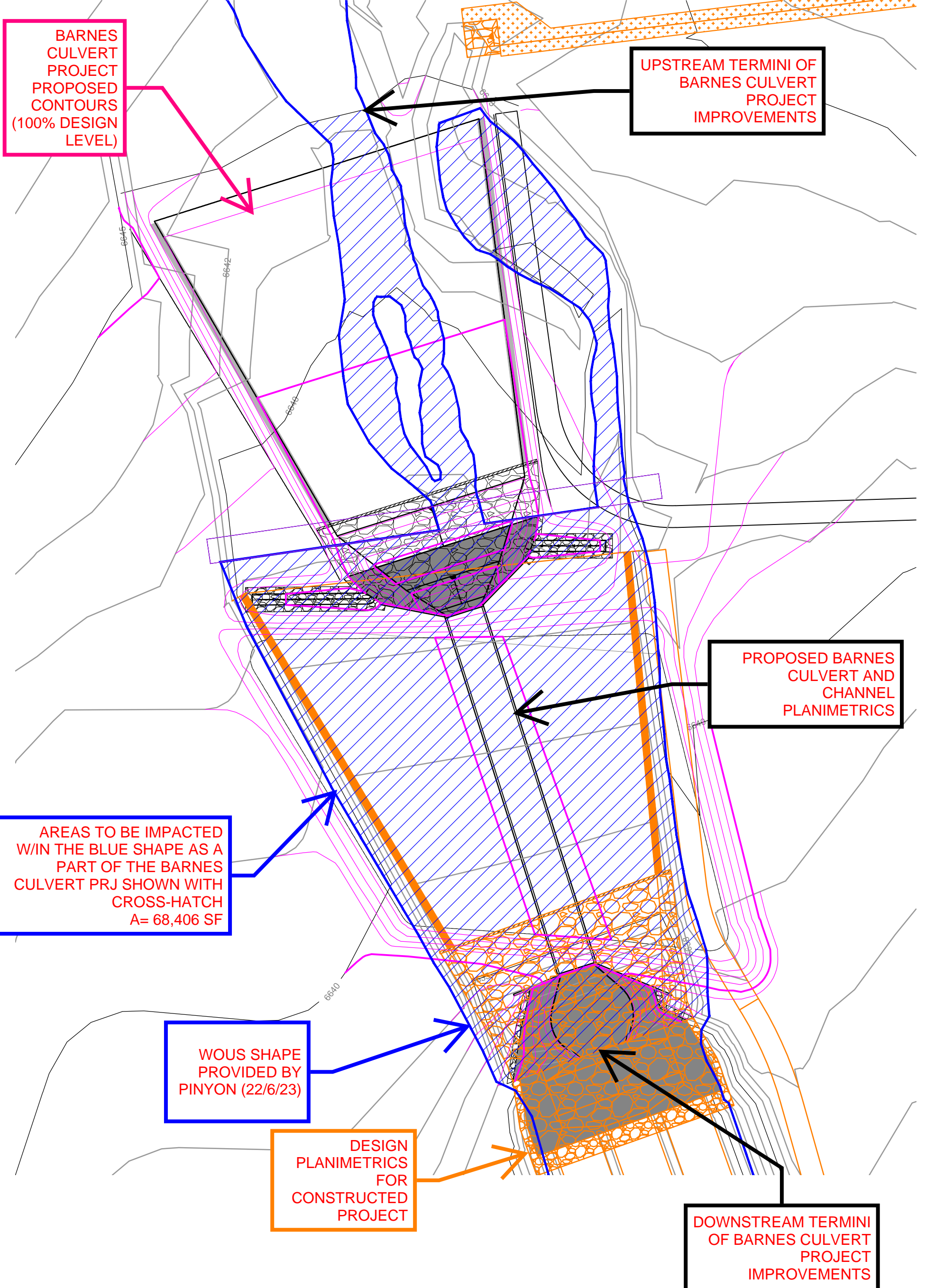

BARNES CULVERT PROJECT PROPOSED CONTOURS (100% DESIGN LEVEL)

UPSTREAM TERMINI OF BARNES CULVERT PROJECT IMPROVEMENTS

PROPOSED BARNES CULVERT AND CHANNEL PLANIMETRICS

AREAS TO BE IMPACTED W/IN THE BLUE SHAPE AS A PART OF THE BARNES CULVERT PRJ SHOWN WITH CROSS-HATCH A= 68,406 SF

WOUS SHAPE PROVIDED BY PINYON (22/6/23)

DESIGN PLANIMETRICS FOR CONSTRUCTED PROJECT

DOWNSTREAM TERMINI OF BARNES CULVERT PROJECT IMPROVEMENTS